



### SCB Series (Built -In Capacitor)

Part No:	Example
SCB-freq	SCB-2.00

SCB Series	Specification
Frequency Range	2.00MHz - 7.99MHz
Frequency Tolerance (25°C)	± 0.5%
Internal Capacitance	C1, C2: 24pF
Frequency Stability over Temp.	± 0.5%
Operating Temper. Range	-20°C to ~ +80°C
Storage Temp. Range	-30°C to ~ +85°C
Frequency Aging (10 Years)	± 0.5 % Max

Part No:	Example
SCB-freq	SCB-8.00

SCB Series	Specification
Frequency Range	8.00 - 40.00MHz
Frequency Tolerance (25°C)	± 0.5%
Internal Capacitance (8.00MHz-20.00MHz)	C1, C2: 30pF
Internal Capacitance (20.01MHz-40.00MHz)	C1, C2: 10pF
Frequency Stability over Temp.	± 0.5%
Operating Temper. Range	-20°C to ~ +80°
Storage Temp. Range	-30°C to ~ +85°C
Frequency Aging (10 Years)	± 0.5% Max

### SCJ Series (Built -In Capacitor)

Part No:	Example
SCJ-freq	SCJ-2.00

SCJ Series	Specification
Frequency Range	2.00MHz - 7.99MHz
Frequency Tolerance (25°C)	± 0.5%
Internal Capacitance	C1, C2: 30pF
Frequency Stability over Temp.	± 0.5%
Operating Temper. Range	-20° to ~ +80°
Storage Temp. Range	-30°C to ~ +85°C
Frequency Aging (10 Years)	± 0.5% Max

Part No:	Example
SCJ-freq	SCJ-8.00

SCB Series	Specification
Frequency Range	8.00MHz - 40.00MHz
Frequency Tolerance (25°C)	± 0.5%
Internal Capacitance (8.00MHz-20.00MHz)	C1, C2: 30pF
Internal Capacitance (20.01MHz-25.99MHz)	C1, C2: 15pF
Internal Capacitance (26.00MHz-40.00MHz)	C1, C2: 5pF
Frequency Stability over Temp.	± 0.5 %
Operating Temper. Range	-20°C to ~ +80°C
Storage Temp. Range	-30°C to ~ +85°C
Frequency Aging (10 Years)	± 0.5% Max

### SCB Series IT-SCB-001

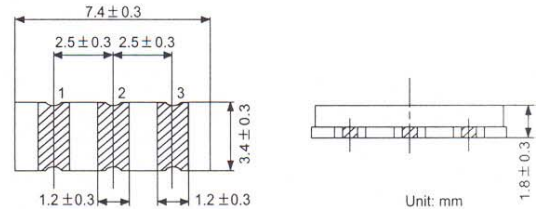

### IT-SCB-002

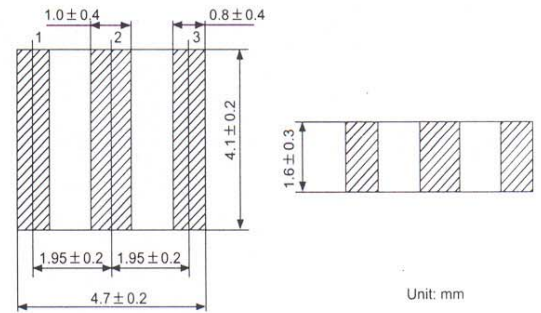

### IT-SCJ-001

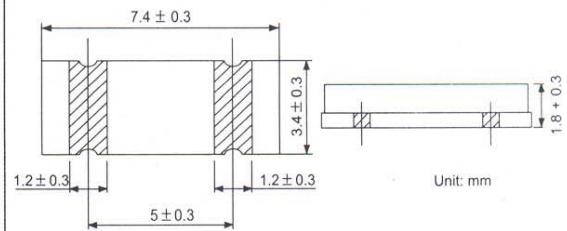

### IT-SCJ-002

